

This map is reproduced from Ordnance Survey material with the permission of Ordnance Survey on behalf of the Controller of Her Majesty's Stationery Office © Crown copyright. Unauthorised reproduction infringes Crown copyright and may lead to prosecution or civil proceedings. Stockport Metropolitan Borough Council 100019571 2019

- KEY:**
- FOOTWAY
 - SHARED FOOTWAY / CYCLEWAY
 - SEGREGATED CYCLEWAY
 - CONTROLLED TACTILE PAVING
 - UNCONTROLLED TACTILE PAVING
 - PROPOSED NEW KERB

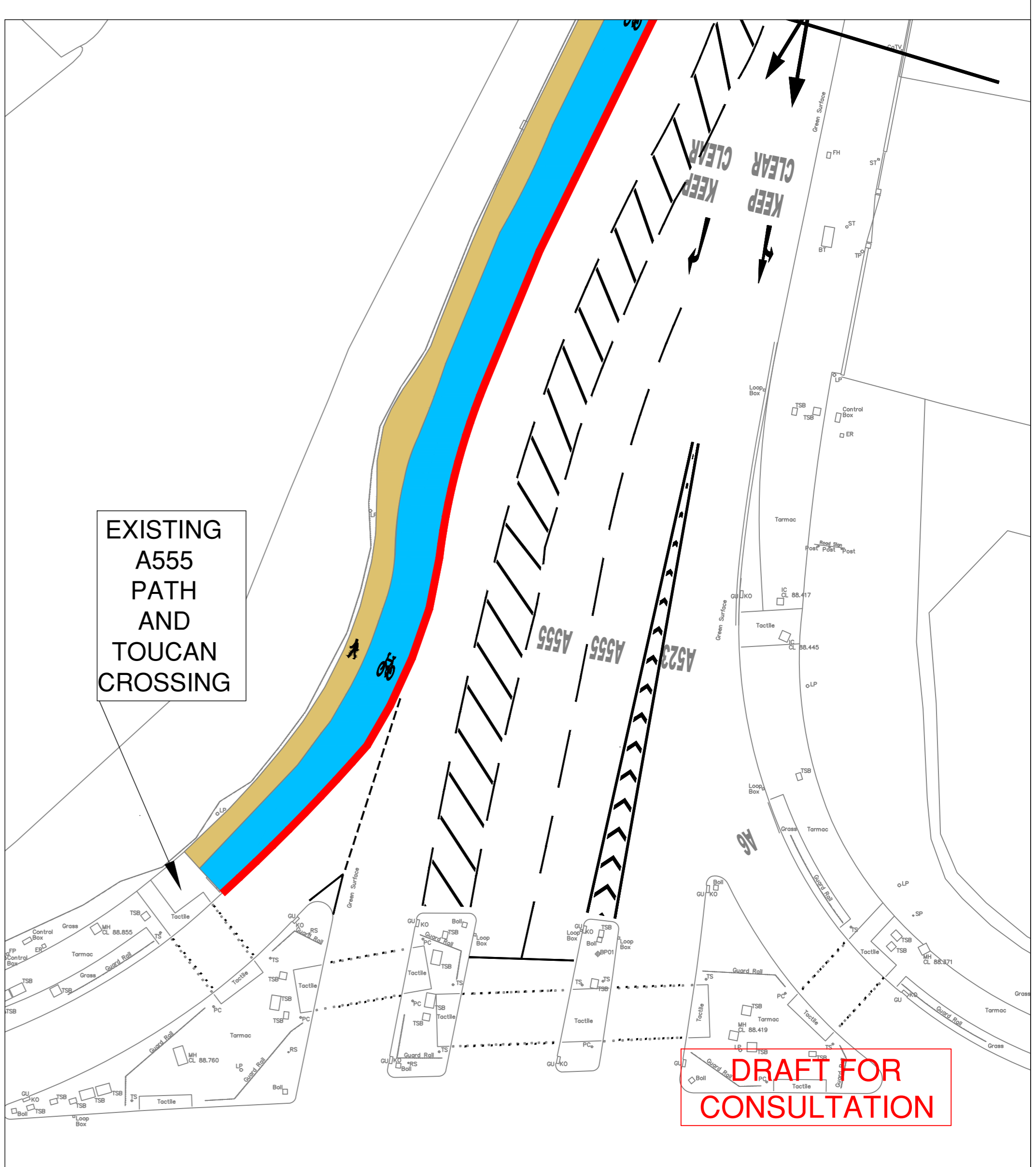
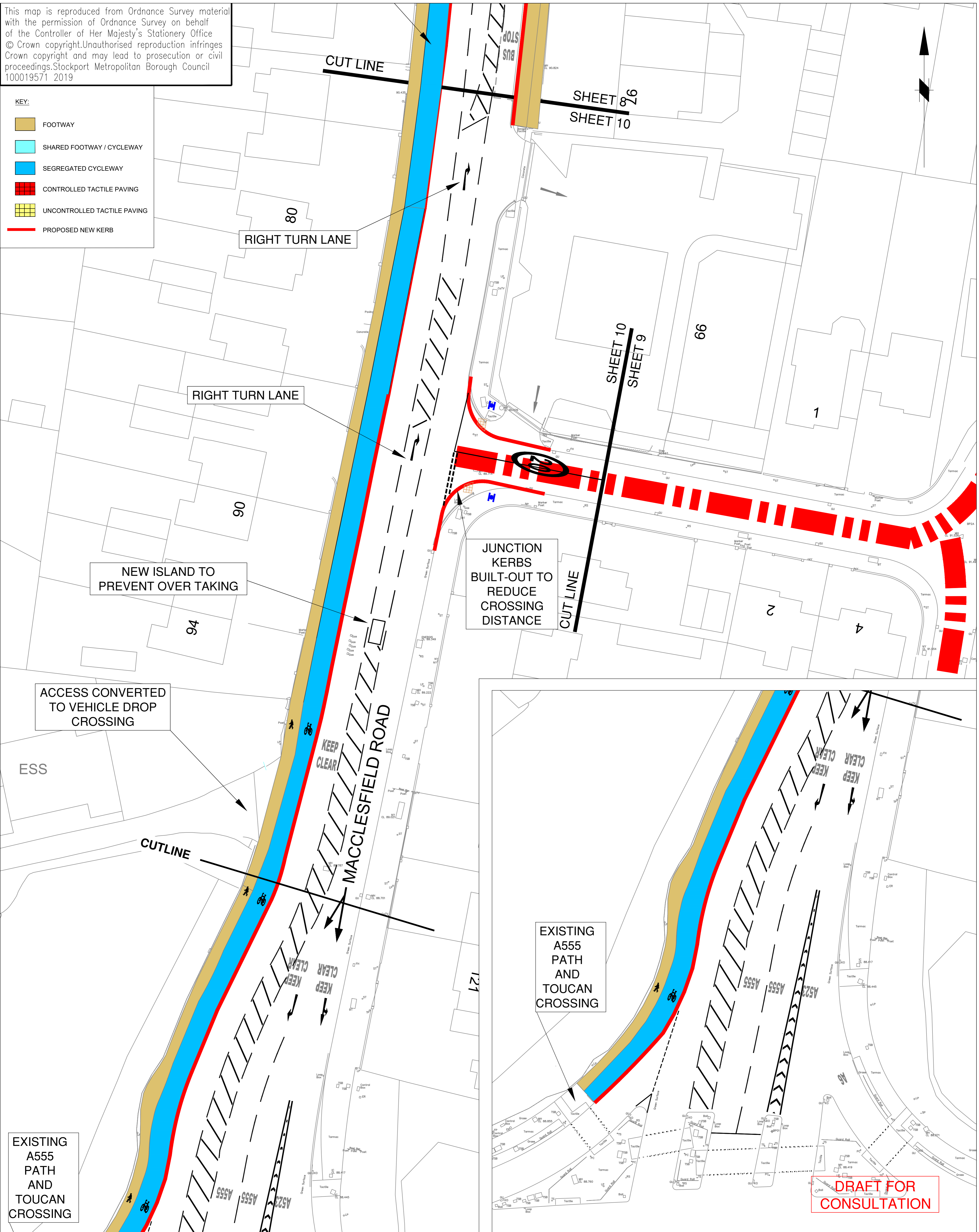

EXISTING A555 PATH AND TOUCAN CROSSING

EXISTING A555 PATH AND TOUCAN CROSSING

DRAFT FOR CONSULTATION



STOCKPORT
METROPOLITAN BOROUGH COUNCIL

HIGHWAYS AND TRANSPORTATION
STOPFORD HOUSE
STOCKPORT SK1 3XE
Tel: 0161 474 2434

CAROLINE SIMPSON
CORPORATE DIRECTOR
PLACE

JOB TITLE **MCF BRAMHALL GREEN - A6 CYCLE FACILITIES G.A.**

DRAWN	ALB	ENGINEER	ALB	CHECKED	DM	APPROVED	MDJ
DATE	23.07.19	DATE	23.07.19	DATE	23.07.19	DATE	23.07.19

SCALE 1:250 @ A1

DRAWING NUMBER F/0275/001-010

Revision

DRAWING TITLE **SHEET 10 OF 11 - FOR CONSULTATION**